

SET UP INSTRUCTIONS:

gawck retractable plus™ / gawck retractable plus, extra wide™

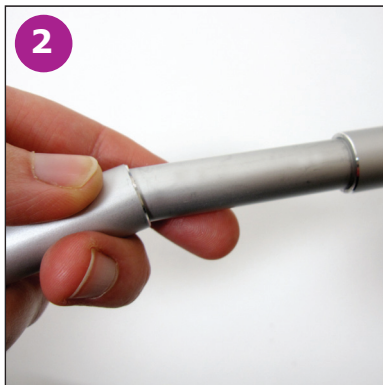

1 Remove all pieces from the transport bag



2 Assemble the bottom section of the pole



3 Insert the end of the pole into the base

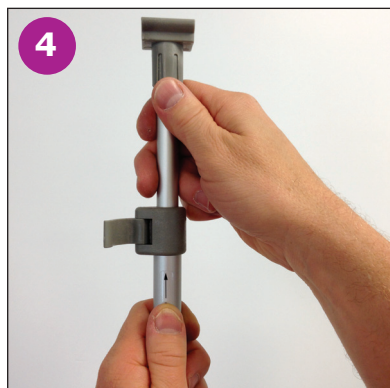

4 Open clamp, extend top of pole as marked, close clamp



5 Carefully tip the pole side of the stand towards you and gently pull graphic rail upwards



6 Insert end of pole into graphic rail as marked



7 Finished piece

NOTE:

When disassembling, hold top rail securely at center. Allow banner to retract slowly and evenly into base.